

Operating Instructions:

Power On/Off and Changing Modes:

- All features of your new Plug-In Micro Series will be accessed through the included remote control.
- To turn your light on/off, press the red button on the top left of your remote control.
- This light has 64 levels of variable light output that can be selected via the “-“ and “+“ buttons on the remote control. Alternatively, there are shortcuts on the remote control for 100%, 80%, 60%, 40%, 20%, and 10% outputs.
- Remote control is powered by a CR2032 battery. Battery life is typically 1 – 2 years. Your Plug-in Micro Series will not function properly and may not turn on or off when battery needs replacement.



Installation Instructions:

Tools required: Screwdriver, drill (optional for wall mount), pencil.

Frame Mount (easiest method)

1. Remove artwork from wall.
2. Locate top center of frame.
3. Attach supplied wall mount to frame using the two short screws approximately ½” - 1” below the top of the frame. *Note exact placement will vary based on frame size, shape, and personal preference. Make sure before fastening these screws to your frame that they remain above the artwork so as not to damage it.
4. Gently guide the neck through the slot in the mount. Using the included hex key tighten the set screw so there is 2” of vertical rod above the mount. *Note: 2” is a good estimate but the height of the neck is dependent on frame size and personal preference. Adjust as necessary.
5. Connect the included power supply to the female DC jack coming from the light.
6. If the power supply is not long enough to reach an outlet, attach the included extension cord.
7. Replace artwork and adjust light placement as necessary. Adjusting neck higher may eliminate glare.

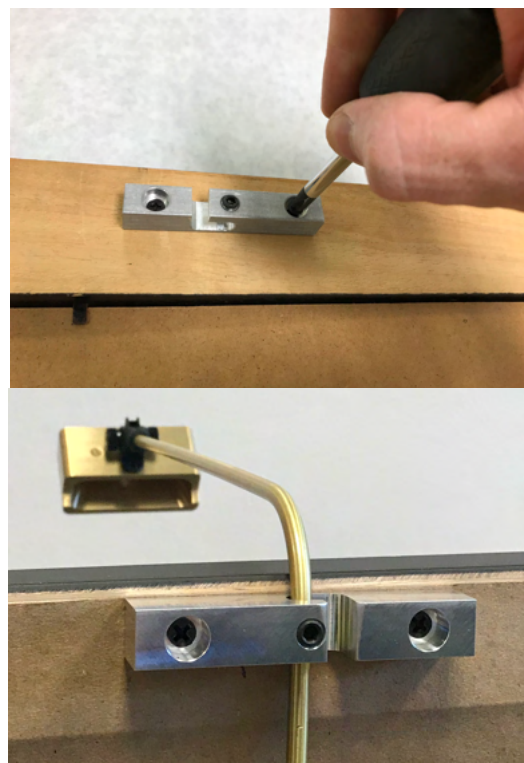

Wall Mount (recommended)

1. Mark the top and center of frame position relative to the wall.
2. Remove artwork from wall.
3. Place the supplied mount ½” - 1” below the top of your mark from Step 1.
4. Using the mounting block (fig 2.1) as a template, mark the position of the two through-holes.
5. Drill two holes using a 3/16” drill bit.
6. Place a dry wall anchor (included) in each hole then attach the mounting block with the supplied screws.



Instructions Continue on Page 2

Wall Mount Continued

8. Gently guide the neck through the slot in the mounting block. Using the included hex key tighten the set screw so there is 2" of vertical rod above the mount. *Note: 2" is a good estimate but the height of the neck is dependent on frame size and personal preference.
9. Adjust as necessary.
10. Connect the included power supply to the female DC jack coming from the light.
11. If the power supply is not long enough to reach an outlet, attach the included extension cord.
12. Replace artwork and adjust light placement as necessary. Adjusting neck higher may eliminate glare.

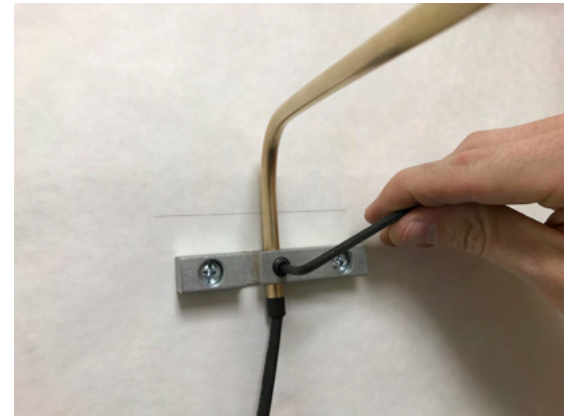

Head Adjustment

- Once mounted, the head of the light can be pivoted to better align the light output to your artwork.
- We recommend adjusting the head so the beam of light begins at the top of your artwork.

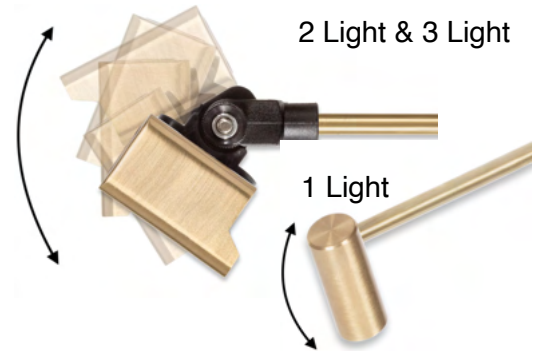

LED Adjustment (Light Placement) - 2 and 3 Light Models Only

1. The 2 outside LEDs within the light head pivot to optimize the placement of light for the specific dimensions of your artwork.
2. To adjust the LEDs, simply use your finger to push them towards the middle or outside of the light head.
3. For greater vertical coverage, push the two outside LEDs together (as shown in A below).
4. For greater horizontal coverage, push the two outside LEDs apart (as shown in B below).
5. Experiment with various placement until you find your preferred setting.

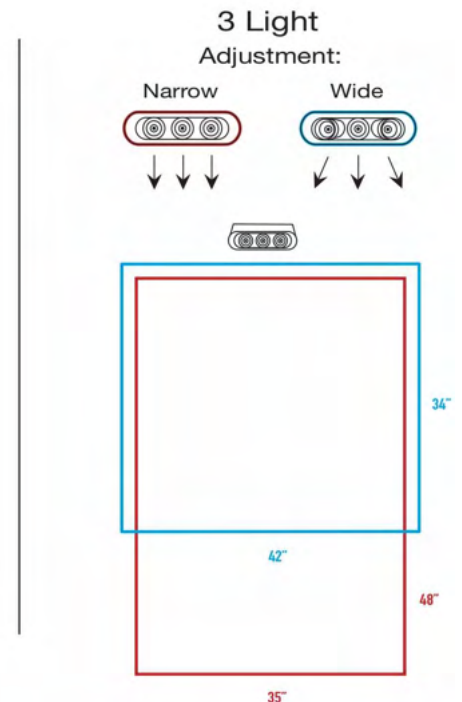
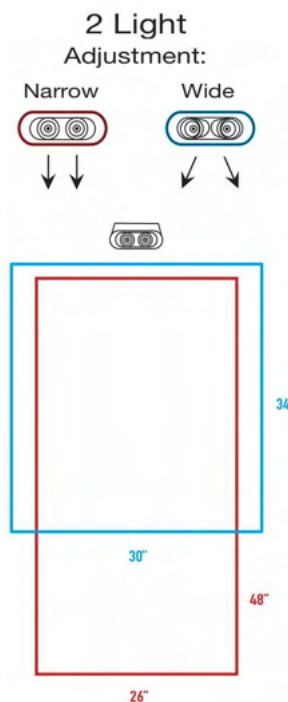

Programming Remote Control to Operate Additional Lights:

1. Unplug the power into the dimmer module (small white box) for 5 or more seconds.
2. Reconnect power then immediately press and hold the 100% and 60% buttons simultaneously for 1 second.
3. The remote is now programmed to the new light.
4. 4) Repeat the process as necessary to continue programming the remote control to other lights.

Operating Warnings:

- Black junction box attached near DC jack on the 1 Light Plug-in Micro Series will become **warm** in operation. Avoid direct contact with artwork or other delicate artwork mediums.
- **AVOID EYE INJURY** - Do not stare directly into beam or shine it directly into anyone's face. Doing so could cause retinal damage.
- Never connect the light to any item other than the supplied power supply. Doing so may damage the product and void your warranty, and could possibly result in fire, electric shock or other bodily injury.
- Use in a dry and safe location. Our products are meant for indoor and dry locations only.
- Inspect your light carefully before use. Product can become damaged in shipping. Contact us if you have any of the following signs of a defective product: cuts or damage to electrical cord, damage to light head, or signs of damage on any part of the product.

Precautions:

- **AVOID EYE INJURY** - Do not stare directly into beam or shine it directly into anyone's face. Doing so could cause retinal damage.
- Never try to disassemble or repair the power supply or this light. Electric shock may result. Contact us for warranty and repairs.
- Never alter the plug on your power supply. If the plug will not fit into the available outlet, have a proper outlet installed by a qualified electrician. Trying to plug into an improper outlet can result in shock.
- Never allow liquids to spill on the power supply or the light and do not connect outdoors, as the unit is not waterproof. Exposure to rain or other liquid could result in fire or electric shock.
- Never connect the light to any item other than the supplied power supply. Doing so may damage the product and void your warranty, and could possibly result in fire, electric shock or other bodily injury.
- Never use a power supply with a damaged or worn power cord or plug. This could result in electric shock, burns or fire. Contact us to obtain a replacement.

PROTECTION OF CHILDREN

- This product is not designed, intended or recommended for children.
- Never allow children to play with, or otherwise handle or operate, the light, its battery or charging apparatus, as injury to themselves or others could result.
- Keep all accessories and components out of the reach of small children. Small parts, in particular, might present a choking hazard to children.